

## PRODUCT FEATURES

- Ultrafast Reverse Recovery Time
- Soft Reverse Recovery Characteristics
- Low Reverse Recovery Loss
- Low Forward Voltage
- High Surge Current Capability
- Low Leakage Current



## APPLICATIONS

- Inversion Welder
- Uninterruptible Power Supply
- Plating Power Supply
- Ultrasonic Cleaner and Welder
- Converter & Chopper
- PFC

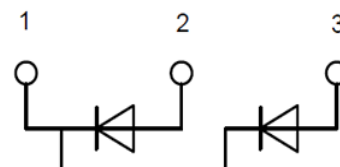

## ABSOLUTE MAXIMUM RATINGS ( $T_C = 25^\circ\text{C}$ unless otherwise specified)

Symbol	Parameter/Test Conditions		Values	Unit
$V_R$	Maximum D.C. Reverse Voltage		600	V
$V_{RRM}$	Maximum Repetitive Reverse Voltage			
$I_{F(AV)}$	Average Forward Current	$T_C=80^\circ\text{C}$ , Per Diode	150	A
$I_{F(RMS)}$	RMS Forward Current	$T_C=80^\circ\text{C}$ , Per Diode	210	
$I_{FSM}$	Non Repetitive Surge Forward Current	$T_J=45^\circ\text{C}$ , $t=10\text{ms}$ , Sine, peak value	1500	
		$T_J=45^\circ\text{C}$ , $t=8.3\text{ms}$ , Sine, peak value	1650	
$I^2t$	For Fusing	$T_J=45^\circ\text{C}$ , $t=10\text{ms}$ , Sine, peak value	11.25	KA <sup>2</sup> S
		$T_J=45^\circ\text{C}$ , $t=8.3\text{ms}$ , Sine, peak value	11.3	
$P_D$	Power Dissipation		416	W
$T_J$	Junction Temperature		-40 to +150	$^\circ\text{C}$
$T_{STG}$	Storage Temperature Range		-40 to +125	$^\circ\text{C}$
$V_{isol}$	Isolation Breakdown Voltage	AC, 50Hz(R.M.S), $t=1\text{minute}$	3000	V
Torque	Module to Sink	Recommended (M6)	3~5	Nm
Torque	Module Electrodes	Recommended (M6)	3~5	Nm
$R_{thJC}$	Junction to Case Thermal Resistance(Per Diode)		0.3	$^\circ\text{C}/\text{W}$
Weight			160	g

MacMic Science & Technology Co., Ltd.

Add: #18, Hua Shan Zhong Lu, New District, Changzhou City, Jiangsu Province, P. R. of China

# MMF150S060DK2B

ELECTRICAL CHARACTERISTICS ( $T_C=25^\circ\text{C}$  unless otherwise specified)

Symbol	Parameter/Test Conditions	Min.	Typ.	Max.	Unit
$I_{RM}$	Maximum Reverse Leakage Current	$V_R = 600\text{V}$		0.5	mA
		$V_R = 600\text{V}, T_J = 125^\circ\text{C}$		10	
$V_F$	Forward Voltage	$I_F=150\text{A}$	1.25	1.7	V
		$I_F=150\text{A}, T_J=125^\circ\text{C}$		1.1	
$t_{rr}$	Reverse Recovery Time ( $I_F = 1\text{A}, dI_F/dt = -200\text{A}/\mu\text{s}, V_R = 30\text{V}$ )		48		ns
$t_{rr}$	Reverse Recovery Time		95		ns
$I_{RRM}$	Maximum Reverse Recovery Current		9		
$t_{rr}$	Reverse Recovery Time		210		ns
$I_{RRM}$	Maximum Reverse Recovery Current		20		

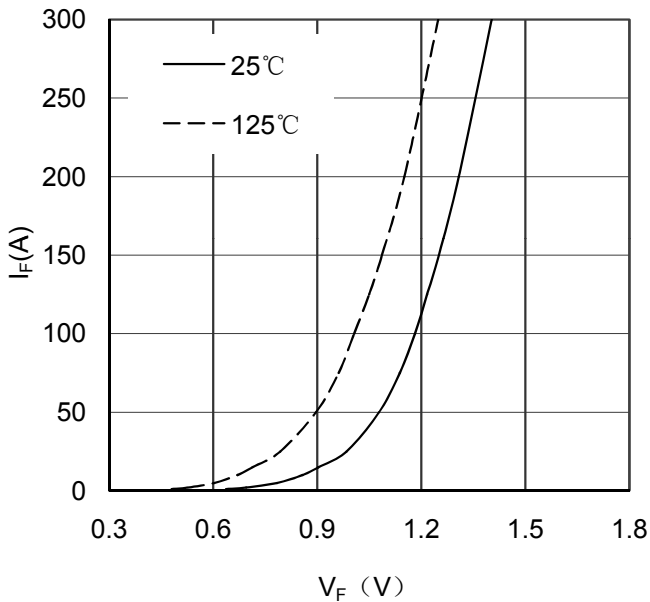

Figure 1. Forward Voltage Drop vs Forward Current

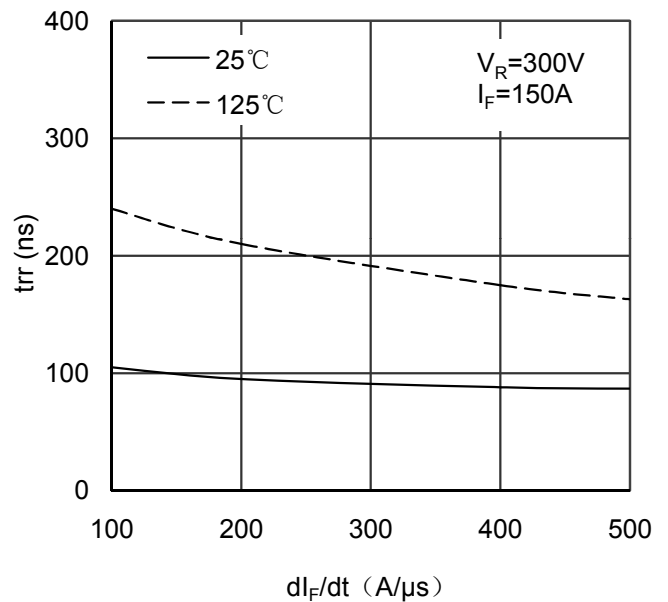

Figure 2. Reverse Recovery Time vs  $dI_F/dt$

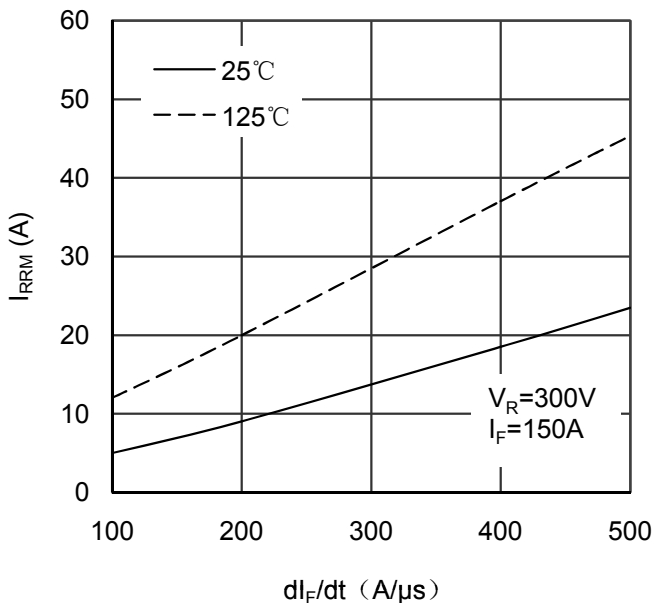

Figure 3. Reverse Recovery Current vs  $dI_F/dt$

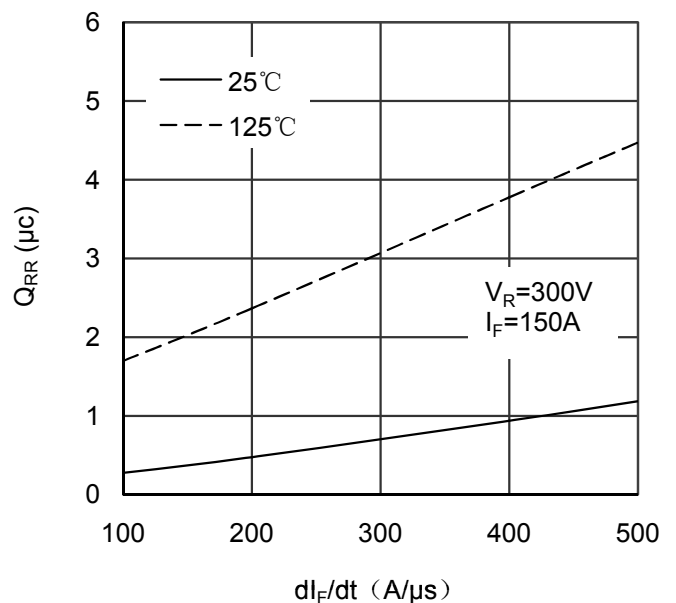

Figure 4. Reverse Recovery Charge vs  $dI_F/dt$

# MMF150S060DK2B

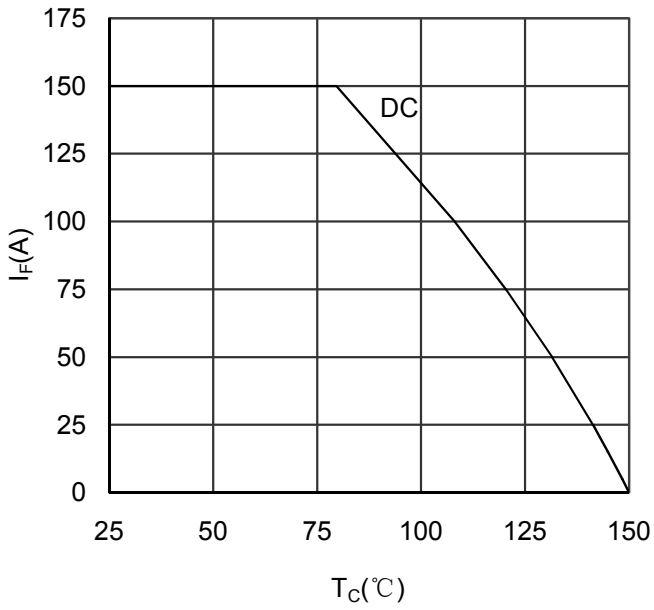

Figure 5. Forward current vs Case temperature

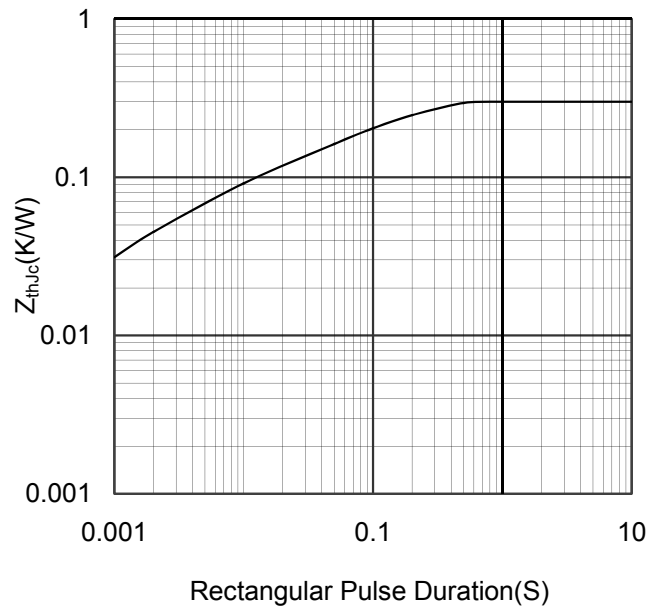
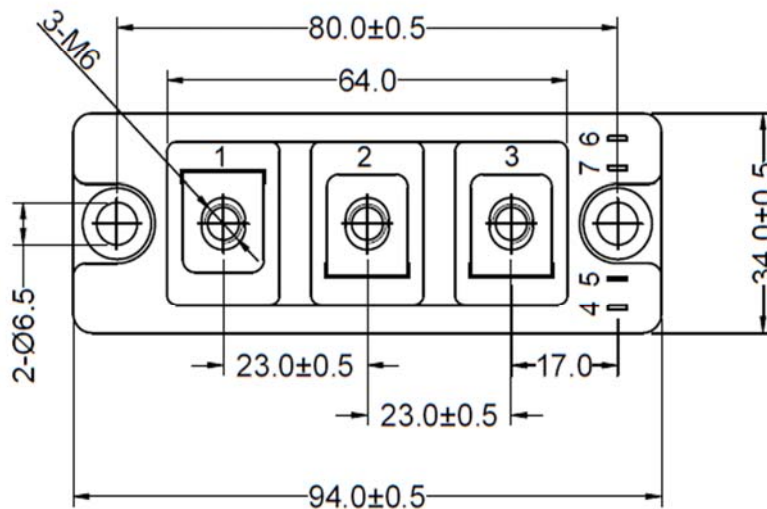
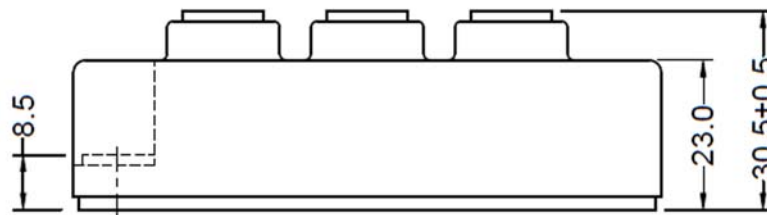

Figure 6. Transient Thermal Impedance



Dimensions in (mm)

Figure 7. Package Outline